

QUEEN VICTORIA®

GUIDE TO ACCOMMODATION & DECK PLANS

BRITANNIA ACCOMMODATION (DINING IN BRITANNIA RESTAURANT — DECKS 2 & 3)

Enjoy the traditional Cunard ocean liner experience with a stay in the Britannia staterooms on QUEEN VICTORIA. This comfortable accommodation combines a pleasant range of wonderful amenities from room service to bathrobes and slippers with dining in one of the most incredible dining rooms on land or sea — the classic, inspiring double-height Britannia Restaurant.

- Bon Voyage half bottle of sparkling wine upon embarkation
- 24-hour room service
- Satellite TV with multi-language film and music channels
- Direct-dial telephone & data port outlet
- Refrigerator, safe, hair dryer
- Bathrobe & slippers
- Nightly turndown service with complimentary chocolate
- Daily shipboard newspaper
- 220V British 3-pin and 110V U.S. 2-pin sockets
- Fine soaps and shampoos



Standard Inside (D3-D8) Approximately 156 square feet.
Two beds, shower.

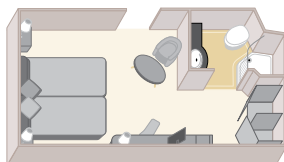

Deluxe Inside (D1-D2) Approximately 203 square feet.
Two beds, shower.

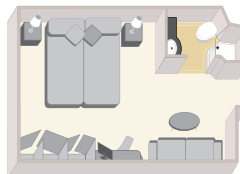

Oceanview (C2-C5) Approximately 180-197 square feet.
Two beds, shower and living area.

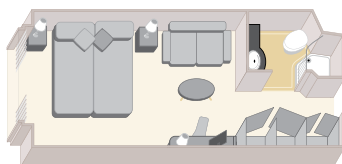

Balcony (A1-A7[^]) Approximately 249 square feet. Two beds, shower, living area and balcony.

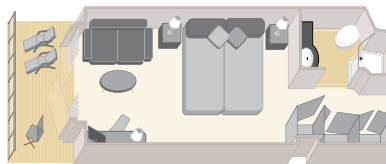

[^]A6 and A7 have obstructed views. Metal-fronted balconies A64003-4042; A7.

PRINCESS GRILL ACCOMMODATION (DINING IN PRINCESS GRILL — DECK 11)

Your luxurious Princess Grill suite offers deluxe surroundings with special amenities such as concierge service and a welcome bottle of sparkling wine. Of course, you'll dine at the exclusive Princess Grill, and enjoy access to the Grills Lounge, the Tuscan-inspired Courtyard and the Terrace.

- Single-seating dining in the Princess Grill, or al fresco dining in The Courtyard
- Access to the Grills Lounge and the Grills Upper Terrace
- Bon Voyage bottle of sparkling wine, mineral water & chocolate-covered strawberries upon embarkation
- Fine linens & duvet, and Pillow Concierge Menu offering nine pillow options
- Fruit basket & bud vase with orchid
- 24-hour room service
- Daily abridged newspaper
- Shoe shine service
- Terry cloth bathrobe & slippers
- Nightly turndown service with complimentary chocolate
- Fine soaps & shampoos



Princess Suites (P1-P4) Approximately 367 square feet. Two beds, bath with shower, living area and balcony.

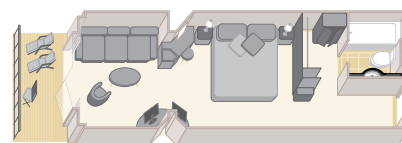

QUEENS GRILL ACCOMMODATION (DINING IN QUEENS GRILL — DECK 11)

Travel doesn't get any better than this — the lavish Queens Grill accommodation on **QUEEN VICTORIA**. Breathtaking suites to settle into, fine dining in the Queens Grill, outdoor dining in The Courtyard, an expansive outdoor Terrace and cultivated mingling in the Grills Lounge.

- Single-seating dining in the Queens Grill, or al fresco dining in The Courtyard
- Access to the Grills Lounge and the Grills Upper Terrace
- Priority embarkation and luggage delivery with separate Grill check-in
- Bon Voyage bottle of Champagne, mineral water & chocolate-covered strawberries upon embarkation
- Fine linens & duvet, and Pillow Concierge Menu offering nine pillow options
- Complimentary in-room bar & fully stocked refrigerator
- Flower arrangement, fruit basket & bottled water replenished daily
- Personalised Cunard stationery & daily abridged newspaper
- In-room board games (chess/backgammon)
- 24-hour room service
- Shoe shine service
- Complimentary canapés
- Turndown service with "Sweet Dreams" surprise on formal nights
- Terry cloth bathrobe & slippers
- Extended line of fine soaps & shampoos; bath salts & manicure kit
- Umbrella and binoculars



Queens Suites (Q5-Q7*) Approximately 536 square feet. Two beds, bath with shower, living area and balcony.

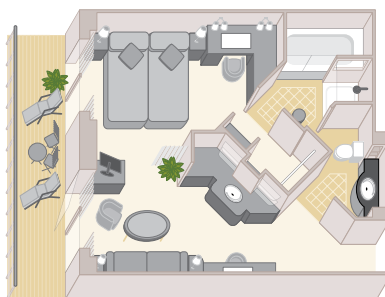

Grand Suites (Q1) Approximately 1,100 - 2,097 square feet on Queen Victoria; 1,375 - 1,493 square feet on Queen Elizabeth. Two beds, bath with shower, living area, dining area and balcony.

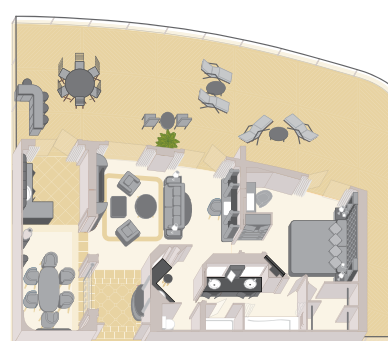

*Wheelchair accessible Q6 Suites have a roll-in shower instead of combination shower/whirlpool tub. Walk-in closet not available in wheelchair accessible Suites. Note: Floor plans and stateroom diagrams represent typical arrangements. Certain staterooms may vary in size and configuration. Square footage varies based on stateroom category and deck location. At time of publication, Queen Elizabeth is still under construction and images featured are from Queen Victoria. Final design, décor and square footage may vary. Contact Cunard for more information. Ships' registry: Great Britain. ©CUNARD 2009. The CUNARD logo and logotype are registered trademarks of Carnival plc, an English Company trading as Cunard Line Ltd. QUEEN VICTORIA is a trademark owned by CUNARD. All rights reserved in the United States and other countries.

▼ DECK 10 ▼

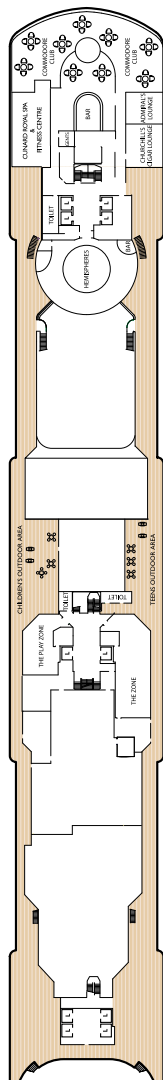

▼ DECK 11 ▼

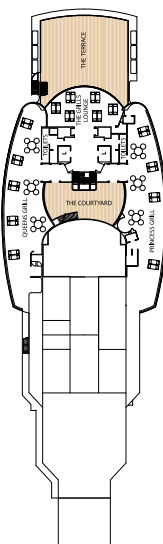

▼ DECK 9 ▼

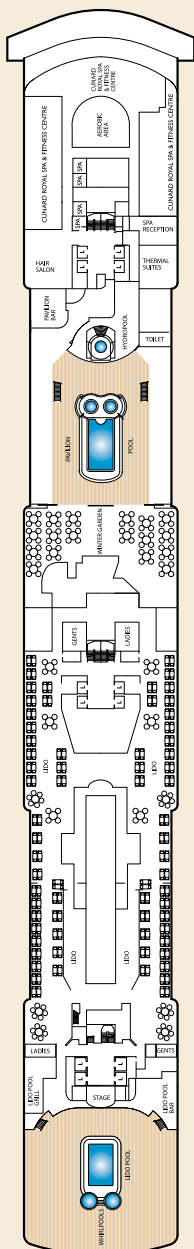

▼ DECK 12 ▼

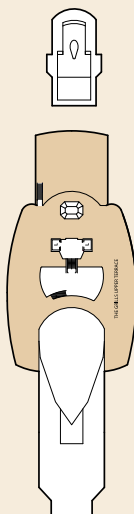

▼ DECK 8 ▼

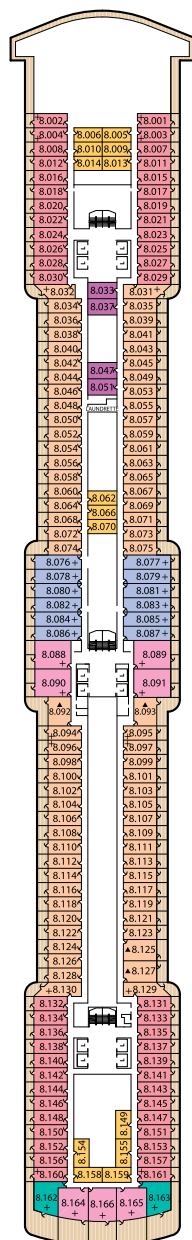

▼ DECK 7 ▼

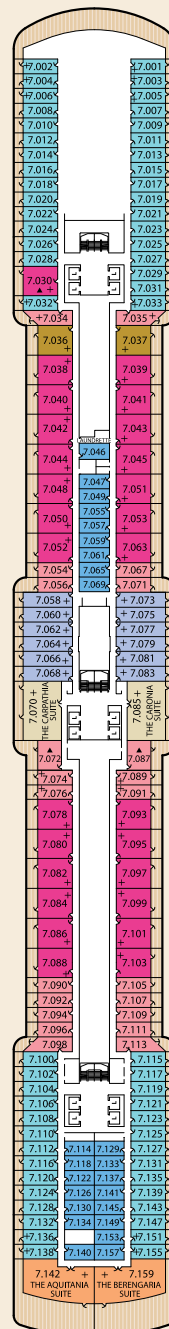

▼ DECK 6 ▼

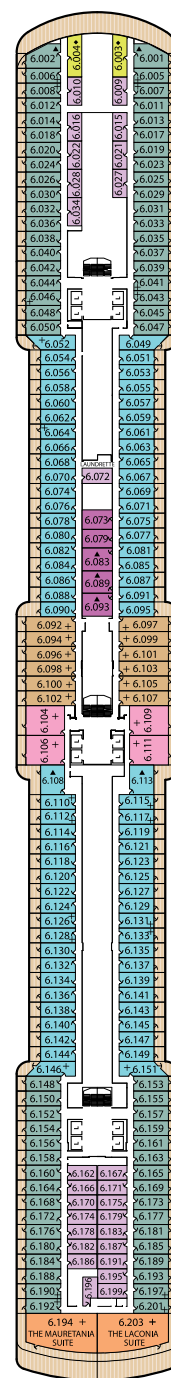

QUEEN VICTORIA

Gross Tonnage: 90,000 GRT
 Guest Decks: 12
 Guest Capacity: 2,000
 Length: 964.5 feet
 Width: 106 feet
 Height: 179 feet
 Draft: 26.2 feet
 Speed: 23.7 knots

- † Indicates 2 lower berths and 1 upper berth
 (The location of these 3rd berth staterooms is provisional)
- + Indicates 3rd berth is a single sofa bed
- ▲ Wheelchair accessible
- L Lift
- * C4 & C5 Staterooms have views obstructed by lifeboats
- ◆ Staterooms 6003 & 6004 have forward facing oceanviews
- ♦ Indicates metal-sided balcony (A64003-4042; A7)
- x Indicates partial obstruction from lifeboat mechanism

Ship deck plans and staterooms are for illustration purposes only.
 Actual staterooms may vary, decks are not to scale.

▼ DECK 5 ▼

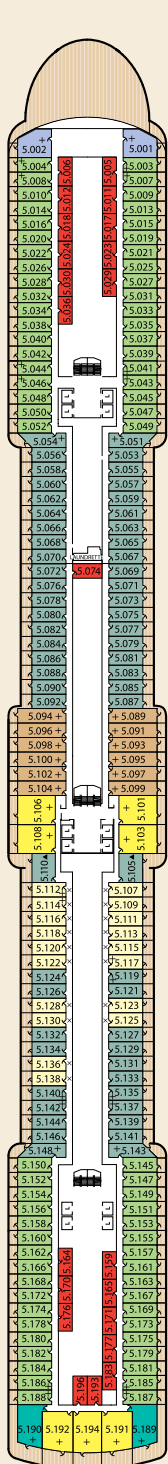

▼ DECK 4 ▼

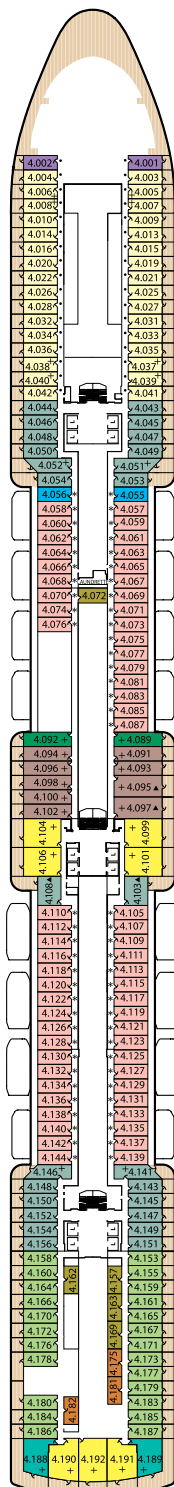

▼ DECK 3 ▼

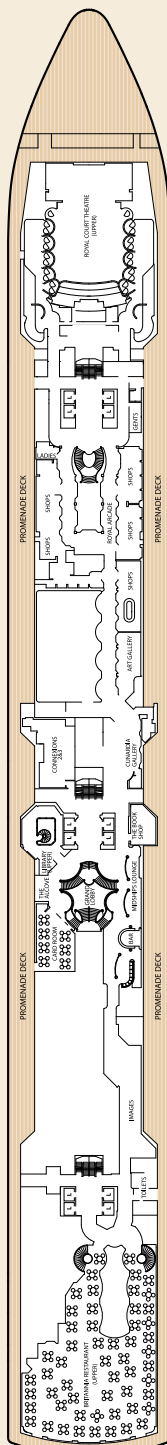

▼ DECK 2 ▼

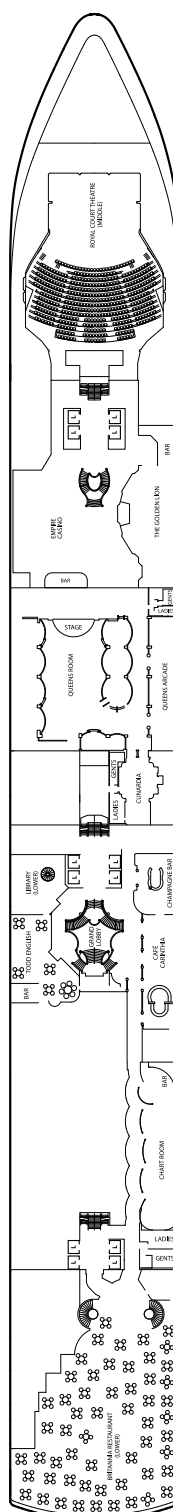

▼ DECK 1 ▼

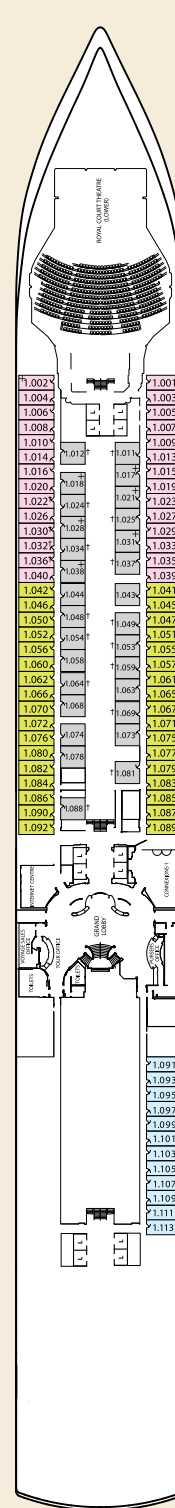

QUEENS GRILL

- Q1 Grand Suites
- Q2 Master Suites
- Q3 Penthouses
- Q4 Penthouses
- Q5 Queens Suites
- Q6 Queens Suites
- Q7 Queens Suites

PRINCESS GRILL

- P1 Princess Suites
- P2 Princess Suites
- P3 Princess Suites
- P4 Princess Suites

BRITANNIA RESTAURANT

- A1 Balcony
- A2 Balcony
- A3 Balcony
- A4 Balcony
- A5 Balcony
- A6 Balcony [Obstructed View*]
- A7 Balcony [Obstructed View*]
- C1 Oceanview
- C2 Oceanview
- C3 Oceanview
- C4 Oceanview [Obstructed View]
- C5 Oceanview [Obstructed View]

- D1 Deluxe Inside
- D2 Deluxe Inside
- D3 Standard Inside
- D4 Standard Inside
- D5 Standard Inside
- D6 Standard Inside
- D7 Standard Inside
- D8 Standard Inside