

m/s Amadeus Brilliant



River cruises on Europe's most beautiful waterways

The m/s AMADEUS Brilliant has the same classic look as its two sister ships - the AMADEUS Elegant (2010) and AMADEUS Diamond (2009) - with a pointed bow and fits, with its 110-m length, perfectly into the elegant AMADEUS fleet. Passengers find the same high standards of service and interior fixtures and fittings as they have become accustomed to aboard the other AMADEUS vessels when they are greeted on the AMADEUS Brilliant by the atmosphere of a modern hotel room with TV, minibar and designer bath in the stylishly furnished 15-m² standard cabins. Most of the 67 cabins have magnificent panoramic windows and French balconies, which turn this mode of travel into a truly memorable experience. The same applies to the 9 elegant suites on the Mozart deck, whose 22-m² of space and equipment offer passengers pure luxury. The AMADEUS club with its library and Internet access is again a particular highlight for passengers, quite apart from the impressive sun deck with its comfortable deck chairs, the golf putting green and giant chessboard. A lift between each deck now makes this relaxed way of travelling even more convenient.

MS AMADEUS BRILLIANT

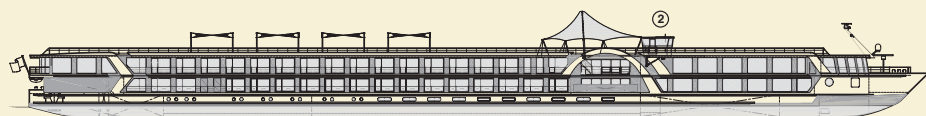

SUN DECK

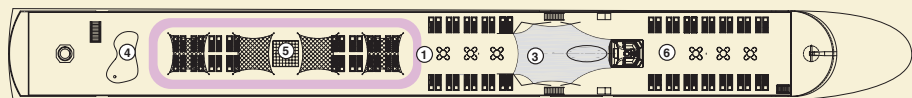

MOZART-DECK

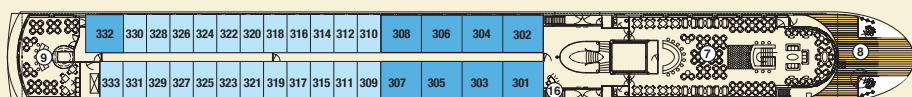

STRAUSS-DECK



HAYDN-DECK

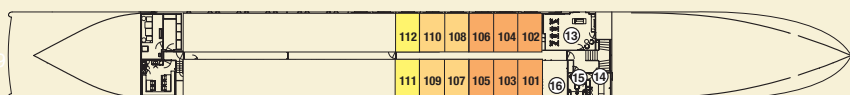

DECKPLAN: 1 Sun deck with deck-chairs · 2 Navigation bridge · 3 Lido-Bar · 4 Golf putting green · 5 Chess board
6 Shuffleboard · 7 Panorama-Bar · 8 Panorama-Deck · 9 Amadeus-Club with Internet station · 10 Panorama-Restaurant
11 Reception 12 Ship's shop · 13 Fitness room · 14 Massage · 15 Hairdresser · 16 Lift

CHOOSE YOUR CABIN

Deck	Category	Size	Window	To open
Mozart-Deck	9 Amadeus-Suites	236 Sq.ft.	Glass doors (French Balcony)	yes
	23 Cabins	161 Sq.ft.	Glass doors (French Balcony)	yes
Strauss-Deck	32 Cabins	161 Sq.ft.	Glass doors (French Balcony)	yes
Haydn-Deck	10 Cabins	161 Sq.ft.	Window	no
	2 Cabins	108 Sq.ft.	Window	no

- Amadeus-Suite - Mozart-Deck
- A-1 - Mozart-Deck
- B-1 - Strauss-Deck
- C-1 - Haydn-Deck
- C-4 - Haydn-Deck
- C-EK - Haydn-Deck (Single cabin)

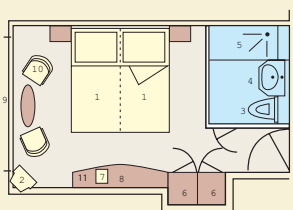

CABIN (161 Sq.ft.): 1 Bed · 2 TV · 3 Toilet
4 Wash basin · 5 Shower · 6 Cabinet
7 Telephone · 8 Writing Desk
9 French Balcony · 10 Chair · 11 Safe

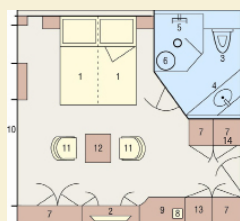

AMADEUS-SUITE (236 Sq.ft.):
1 Bed · 2 Flatscreen-TV · 3 Toilet
4 Wash basin · 5 Shower
6 Stool · 7 Cabinet · 8 Telephone
9 Desk · 10 French Balcony · 11 Chair
12 Table · 13 Mini Bar · 14 Safe

TECHNICAL DATA:

Built:	2011
Draught:	1,30 m
Height above water:	5,85 m
Length:	110 m
Breadth:	11,40 m
Speed:	25 km/h
Tonnage:	1.566 t
Crew members:	ca. 40
Cabins/Suites:	67/9



Amadeus-Suite Mozart-Deck



Cabin Mozart-/Strauss-Deck

